

## NABIC SAFETY RELIEF VALVES

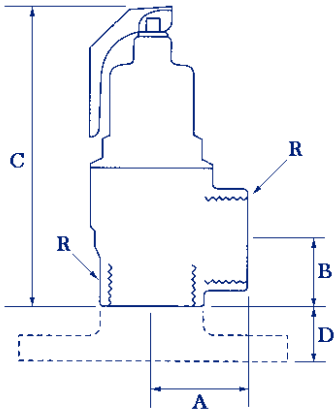

### 542

### STANDARD LIFT SAFETY RELIEF VALVE



#### Part No. 542

#### STANDARD LIFT TYPE SAFETY RELIEF VALVE WITH EASING LEVER

The Nabic 542 safety valve is an extremely versatile valve, suitable for use on hot water, steam or air. Although designed primarily for protection of hot water boilers, it's wide range of applications make it an ideal general purpose safety valve.

The Nabic 542 is of gunmetal construction, with diaphragm protected working parts and P.T.F.E. to metal seating. All wetted parts are manufactured from dezincification resistant materials, approved by the Water Research Centre for use on potable water.

Inlet and outlet connections are of equal size, with female threads to BS 21. Sizes, from DN32 upwards, are also available with flanged inlet connections.

SIZE	R	A	B	C	D
DN15	½	30	23	113	-
DN20	¾	34	23	118	-
DN25	1	39	27	132	-
DN32	1¼	46	33	153	27
DN40	1½	54	38	198	27
DN50	2	64	46	236	27
DN65	2½	76	55	275	28
DN80	3	90	65	335	31

**THIS PRODUCT IS STOCKED UNSET & CAN BE SET TO YOUR EXCACT REQUIREMENTS**

#### Also Available

Part No. 542L

The Nabic 542L range are intended for use where pressure tightness is required on the discharge side of the valve. They are ideal for pump relief, bypass relief, outside installations an inflammable fluids.

The valves are of a gunmetal construction with top guided copper alloy parts, chrome vanadium spring and PTFE to metal seating. O-ring seals ensure pressure tightness at cover and cap joints.



#### Features & Benefits

- Approved to BS6759.
- Resilient PTFE seating design.
- Diaphragm protected working parts.
- WRASA pproved.
- UKWFBFS listed.
- Padlock available.

#### Pressure & Temperature

Pressure range:-

0.3 to 10.5 bar.

Temperature Range:-

Up to 190°C.

When ordering, the following information is necessary to ensure that the correct size and type of valve is selected.

1. Service.
2. Application.
3. System working pressure.
4. Set pressure.
5. Maximum Capacity
6. Inlet connection.